

# Gorilla® Heavy-Duty Construction Adhesive

PTY501 For Build-A-Berm Barrier, Metals, Masonry, Glass, Plastics & Wood, 6 per box

Gorilla's heavy-duty construction adhesive works great with PIG products and lets you create an extra-durable bond almost anywhere!

- Creates a flexible, liquid-tight all-weather bond that lasts longer, indoors or outdoors, than similar adhesives.
- Dispenses easily in a nice bead of low-odor, non-foaming adhesive.
- Ideal for both filling gaps and bonding materials.
- Bonds to most surfaces, from metal, wood and fiberglass to brick, drywall, landscaping and more.
- Meets ASTM D3498 specifications and is VOC compliant.
- Fast-grab formula holds in 30 seconds and withstands the environment to last.
- Not recommended for use on polyethylene, polypropylene, bitumen or similar materials.

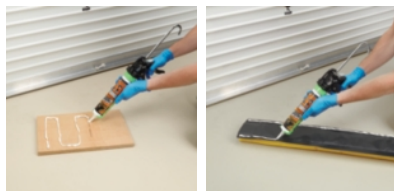

## Specifications

Style	Adhesive
Use With	Build-A-Berm Barrier, Metals, Masonry, Glass, Plastics & Wood
Brand	Gorilla
Volume	9 fl. oz. Cartridge
Sold as	6 per box
Weight	7.2 lbs.
Color	White
Composition	Limestone 30-60% Carbonic acid, calcium salt (1:1) 10-30% Stearic Acid 1-5% Quartz .1-1%
Shelf Life	2 years
UNSPSC	47131903
Pigalog® Page Number	<a href="#">Page 250</a>

## Metric Equivalent

**Weight**

3.3 kg

## Technical Information

### US Only

This product can ONLY be shipped to the United States.

### Certifications, Approvals and Ratings

ASTM C557, ASTM D3498, AFG-01

### Technical Documents

Gorilla Glue Construction Adhesive



**New Pig**

World's best stuff for leaks, drips and spills.

**One Pork Avenue • Tipton, PA 16684-0304**

1-855-493-4647 • Fax: 1-800-621-7447 • [newpig.com](http://newpig.com) • [hothogs@newpig.com](mailto:hothogs@newpig.com)